

# KaysenBetten

Care cots for children

...the original!

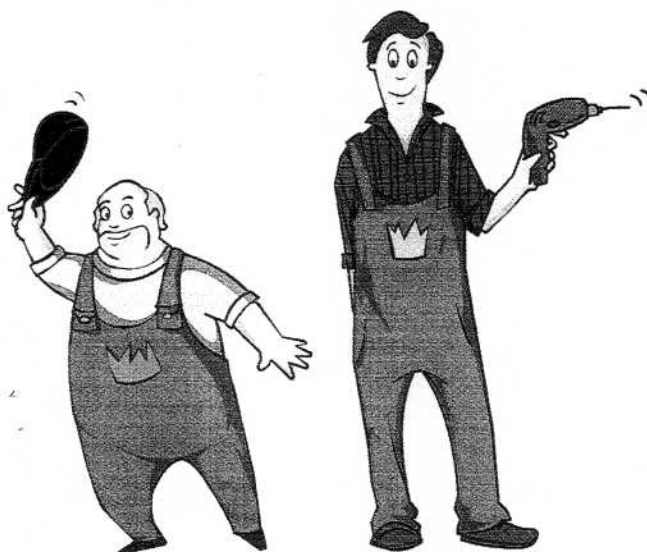

**Assembly Instructions**  
for your new Hannah - care cot

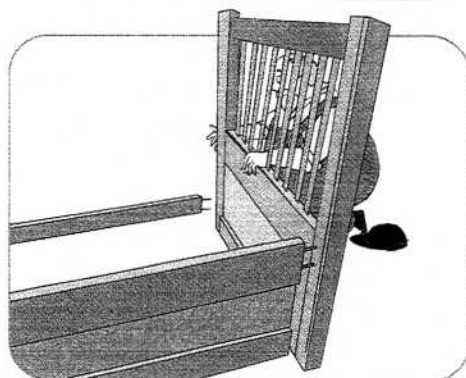
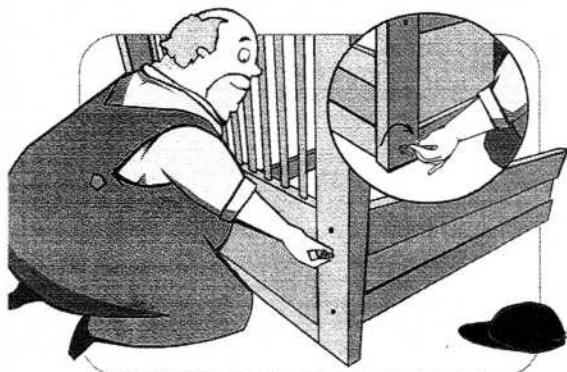
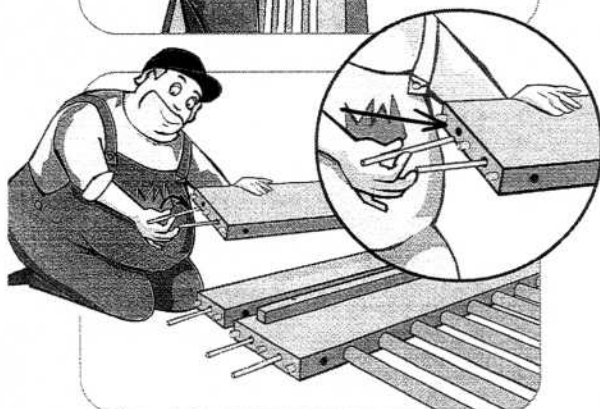
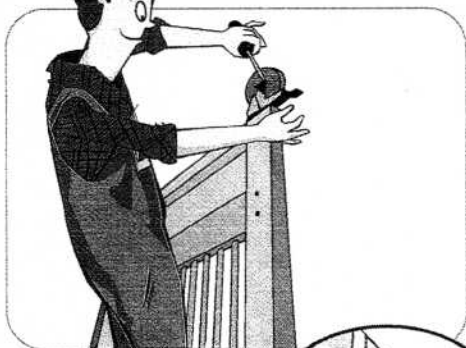

Hello!

Nice to meet you!

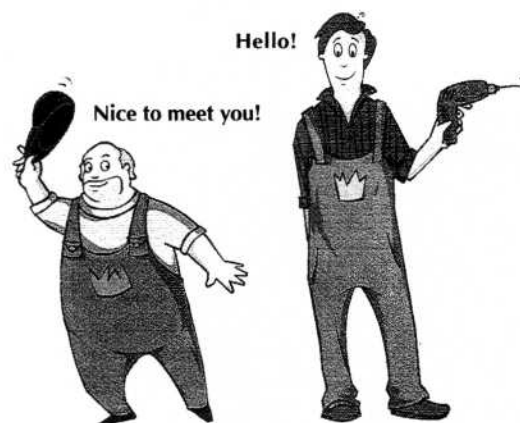

These are our mechanics  
Robert and Stefan.  
They will help you  
to assemble your KayserBed!

## Assembly Instructions for your new Hannah - care cot

The assembly must be on a level surface.

If your bed is equipped with a set of castors then please screw them first into the holes drilled under the side frames (drawing left above).

Please lay the architraves ④ + ⑤ and the back part ② on the ground in order to push in the transverse nuts ⑨. Now screw in the threaded bars ⑦.

Set up one side frame ①. At first, install the rear architrave ④ by putting it with the threaded bars through the lower drilled holes of the side frame. The wooden pegs must fit properly into the drillings. Bolt the architrave with a brass cap ⑩. Now, the construction stands steady already!

After this, bolt the front architrave ④ (with the groove upward) to the side frame. Now push the aperture ⑥ into the groove of the installed architrave, put the upper architrave ⑤ onto the aperture and bolt them to the side frame as well.

Set up the second side frame ① so that the architraves ④ + ⑤ can be hung in. Secure this connection with loosely screwed brass caps.

Now the back part ② has to be put between the side frames. Fit it into the first frame and then push the second side frame onto the threaded bars (drawing below).

(For the Hannah 135 only: Screw the lower back part with brass caps securely to the side frame. Now the upper back part has to be put on the lower one and must be screwed securely to the same side frame. After this, screw the second side frame with brass caps.)

Secure all threaded bars with brass caps. In order to avoid tilting, firstly screw all brass caps on one side and then those on the other side.



The bed is now ready so that the sleeping platform (12) can be inserted. At first, take the control units out of the packaging. Then you need a second person to help with the sleeping platform. To avoid pinching your fingers, hold it from the inside. The sleeping platform needs to be led carefully between the side frames and is laid down onto the wooden strips of the architrave and the back part. (If your cot is electronically adjustable, then please make sure that the cables are underneath in order to avoid them being trapped. Install the switch box (14) with the screws provided (15) on the exterior of a side frame (out of reach of the patient). For further information concerning the sleeping platform, please read the enclosed operating instructions).

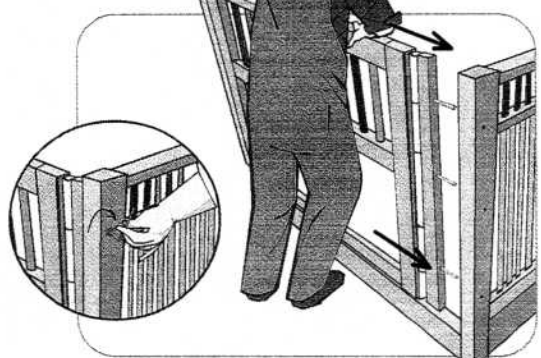

After screwing the threaded bars (8) into the assembly strips of the folding doors you should insert the doors with the lower guide pin into the aluminium profile of the architrave. Then push them against the side frame. Finally, screw the brass caps (10) onto the three threaded bars.



For mounting the locking bar, please put the console (17) in the drilled hole of the corner post on the head and foot side, adjust them and then secure this connection with screws.

Please put the first dowel on one side of the locking bar (18) in the console (17) of the corner post, then the second on the other side. The sheet metal overlaps the door slot.

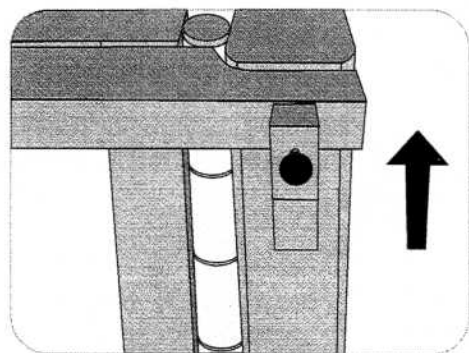

You can lock the bar by pushing the (wine red) knob on the right and left side in the console. The bed is now locked.

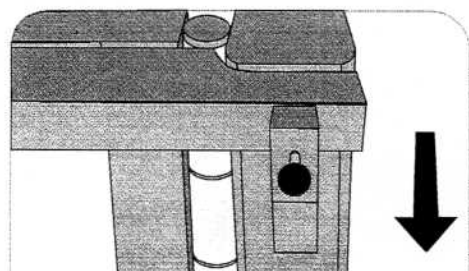

To unlock the bed, please put the security knob out of the consoles.

Now your new Hannah-cot is ready to use.

## Parts list and explosion views of your new Hannah - care cot

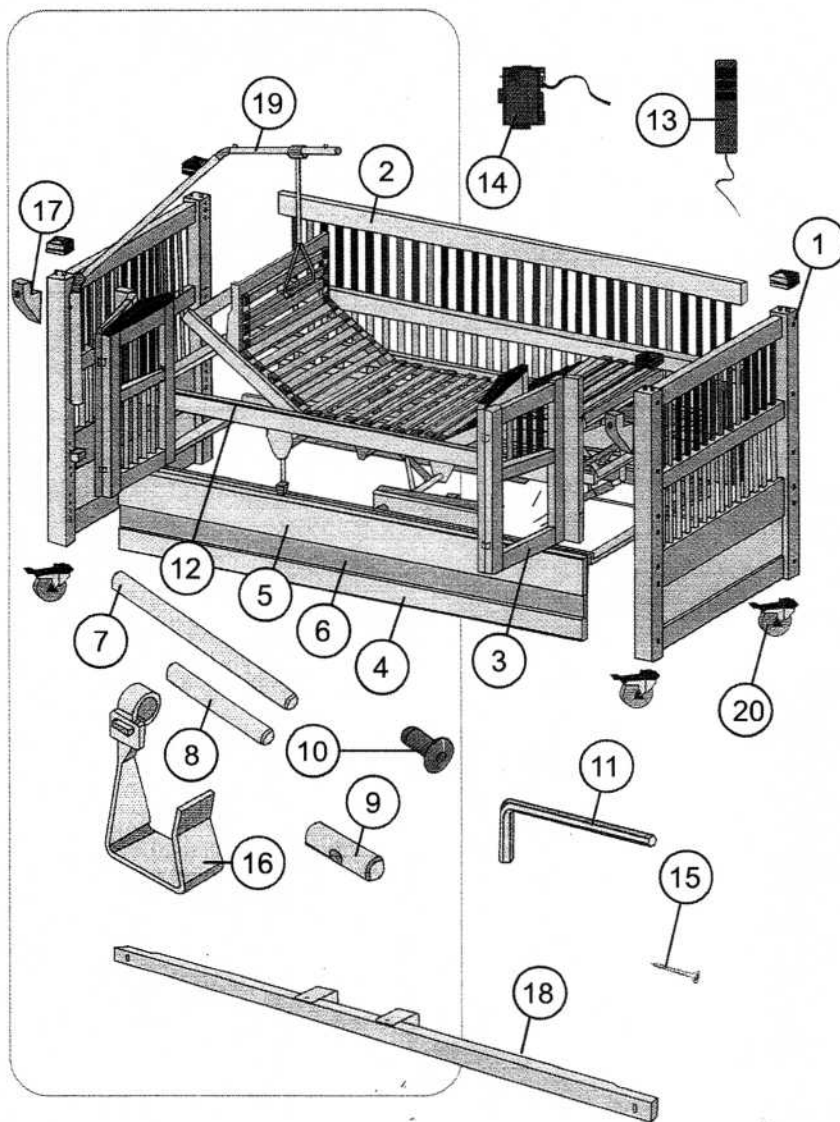

| Pos.   | Qty. | Designation                                     |
|--|------|---|
| <b>Wooden surround</b>                       |      |   |
| 1  | 2    | side frame                                      |
| 2  | 1    | back part                                       |
| 3  | 2    | folding door                                    |
| 4  | 2    | connecting architrave 90mm                      |
| 5  | 1    | architrave 150mm                                |
| 6  | 1    | front aperture                                  |
| <b>Fittings</b>                              |      |   |
| 7  | 14   | threaded bars M8x140mm                          |
| 8  | 6    | threaded bars M8x110mm                          |
| 8  | 8    | threaded bars M8x110mm,<br>(for Hannah 135/170) |
| 9  | 14   | transverse nuts                                 |
| 10   | 20   | brass caps                                      |
| 10   | 22   | brass caps,<br>(for Hannah 135/170)             |
| 11   | 1    | allen key                                       |
| <b>Sleeping platform</b>                     |      |   |
| 12   | 1    | sleeping platform with slatted frame            |
| 13   | 1    | manual control switch*                          |
| 14   | 1    | security switch box*                            |
| 15   | 4    | screws for switch box (4x25mm)                  |
| 16   | 1    | mounting for power cable*                       |
| *(only with electronic sleeping platform)    |      |   |
| <b>External door security locking system</b> |      |   |
| 17   | 2    | consoles  |
| 18   | 1    | lock bar  |
| <b>Optional</b>                              |      |   |
| 19   | 1    | lifter  |
| 20   | 4    | castors   |

**KayserBetten**

Rieper Straße 12  
D-29683 Dorfmark  
Telefon: +49 5163 / 290044  
Telefax: +49 5163 / 290049  
www.kayserbetten.de

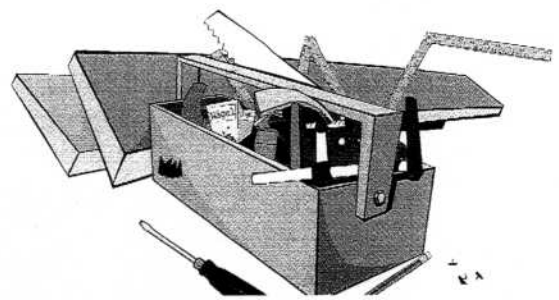

## Operating instructions

Electrically adjustable crib

**Hannah**

**100 x 200 cm**

For domestic care

With the care bed "HANNAH" you have purchased a leading product which possesses an optimum of technical equipment. We hope that this advantage can contribute at a large extent to your well-being.

Series-No.:

Delivery date:



## EU – Declaration of conformity

Manufacturer: KayserBetten GmbH & Co. KG  
Rieper Str. 12  
29683 Bad Fallingbostel-Dorfmark

We confirm hereby in sole responsibility that the product which is marked by the CE-characteristic

**Designation** electrically adjustable child crib for handicapped children

**Type** KayserBett Type "Hannah"

correspond to the fundamental requirements of the European Union – guidelines:

|                        |   |
|------------------------|---|
| 93/42/EEC attachment I | EU-guideline on medicine products             |
| 89/336/EEC             | EU-guideline on electromagnetic compatibility |

This declaration is valid on indefinite time for the product specified above which carries the CE characteristic.

The technical documentation is completely present. The associated operating instruction is attached to the product.

Dorfmark, 01.07.2003



Peter Kayser / Managing director



Torsten Kappenberg / Managing director

# Contents

|   |    |
|---|----|
| EU – Declaration of conformity .....  | 2  |
|  Safety references ..... | 4  |
| Technical Data .....  | 6  |
| Beginning of operation .....  | 7  |
| Select a suitable location for the crib .....   | 7  |
| Assembly of the crib .....  | 7  |
| Connecting the power supply .....   | 7  |
| General reference to the electromagnetic compatibility .....  | 7  |
| Ranges of application / indication / contraindication .....   | 7  |
| Description of functions .....  | 8  |
| Moving the crib .....   | 8  |
| Handling of the folding doors .....   | 8  |
| Accessories .....   | 9  |
| Care and disinfection of the crib .....   | 9  |
| Storage of the crib .....   | 10 |
| Maintenance .....   | 10 |
| Disposal of the crib .....  | 11 |
| Guarantee .....   | 11 |
| Explosion view .....  | 12 |
| Maintenance records first measurement KayserBetten due to VDE 0751 .....                                  | 13 |
| Records of functional test and briefing .....   | 15 |
| Maintenance records KayserBetten due to VDE 0751 .....  | 16 |

Having delivered the crib to the user  
please fill in the maintenance records First Measurement  
and the records of briefing.





## Safety references

### Please consider these references carefully

a)



#### **Danger of clamping**

No articles or parts of the body of other persons must be in the movement range of the crib while using the adjustment functions.

b)



#### **Danger of clamping**

No parts of the body of the patient must jut out of the lying surface while using the adjustment functions.

c)



#### **Danger of falling out of Bed**

The side lattice only offers protection against rolling out if the backrest and the mechanical foot adjustment are in the horizontal position.

d)

If you want to dismantle the crib, please make sure that there is no person in it.

e)

The power plug must be plugged out before you can move the crib. The lead cable with the power plug must not be dragged along the floor. The rolled up mains cable can be hung e.g. over a mattress guidance of the lying surface.

f)

The mains cable must lie free and must not be clamped, because it is carried with the height adjustment of the crib.



#### **Attention**

**If the mains cable or other wiring of the crib are damaged, they must be replaced by the manufacturer or its authorised customer service in order to avoid endangerments. The manufacturer will put connection diagrams for a professional repair at the disposal of its customer service or authorised technical staff.**

g)

The crib must not be used in highly combustible areas.

h)

In order to avoid endangerments by false operations, the blocking and/or unblocking of the manual control switch (pos.9, page 12) by using the removable key is only to be done by instructed, authorised technical and/or maintenance staff.

i)



#### **Danger of falling out of bed**

With unsupervised patients the crib must be driven into its lowest position, so that the danger of falling out of the crib is minimised.



j)

The crib must not be used for transporting the patient.

k)

Attention! Unlike normative recommendations the head / foot section cannot be removed without tools for constructive reasons.

l)



### **Incorrect use**

The incorrect use of the bed can endanger occupants and others. This includes, for example:

- using bed as a means of transport
- incorrect operation of electrical functions and uncontrolled positioning
  - allowing care-receivers to operate bed without prior instruction
  - simultaneous operation of electrical functions by different people
- holding keys depressed or constantly pressing different keys ("piano playing")
  - connecting electrical devices to the bed other than those intended
    - moving bed by pulling on power cable
    - removing plugs from sockets by pulling on cable
  - using bed on a sloping floor with a gradient greater than 10%
  - moving bed with extended castors when it is not in lowest position
- careless use of spiral cable on manual control unit, thus risking entanglement of bodily extremities, eg fingers, toes
- the simultaneous or random operation of keys that can lead to unintended movement of the sleeping platform

## Technical Data

|  |                                 |
|--|---------------------------------|
| • safe lifting capacity                        | : 170 kg                        |
| • max. patient weight                          | : 150 kg                        |
| • max. weight for lifter                       | : 80 kg                         |
| • used mattress                                | : max. 7 in (18 cm) thickness   |
| • height adjustment of lying surface           | : 19 in (47 cm) – 34 in (87 cm) |
| • castors                                      | : without                       |
| • nominal voltage                              | : 100-240 V                     |
| • nominal frequency                            | : 50/60 Hz                      |
| • nominal current in operation                 | : max. 2.0 A                    |
| • nominal standby power consumption            | : max. 3 W                      |
| • nominal operation/standby period             | : 10%, ON 2 min / OFF 18 min    |
| • primary fuse                                 | : thermal fuse                  |
| • application class                            | : security class IPX4           |
| • operating noise                              | : 45 dB(A)                      |
| • total weight                                 | : 170 kg                        |
| • lowest position with mattress (12 cm thick)  | : 35 cm                         |
| • highest position with mattress (12 cm thick) | : 105 cm                        |
| • manufacturer of the electric drive           | : Limoss                        |
| • type/designation of the electric drive       | : Limoss MD200                  |
| • lying surface                                | : metal                         |

With any further questions please ask the manufacturer or the authorised specialist dealer.

# Beginning of operation

## **Select a suitable location for the crib**

- Only usable in domestic environment with dry interior.
- Only to set up on horizontal and firm underground.
- The crib has to be attached only onto plug sockets with FI protection. Please do not use any unnecessary extension cords (only with electrically adjustable sleeping platforms).

## **Assembly of the crib**

Please assemble the crib Hannah in accordance to the assembly instructions you will find attached to these operating instructions. Pay attention to firm connections.

## **Connecting the power supply**

- Untie the rolled mains cable.
- Please put the power plug into the plug socket and press the green button on the power plug. The adjustment motors are now ready to use. In case that the motors are not working after a couple of weeks in which they are not used, then press the green button again.

## **General reference to the electromagnetic compatibility**

The electric drives correspond to the substantial protection requirements which are mentioned in the guideline of the advice for the adjustment of the regulations of the member states for the electromagnetic compatibility (EMV) (86/336/EEC). However, it cannot be completely excluded that under certain circumstances a mutual disturbance in particular when using mobile phones arises among electrical devices.

## **Ranges of application / indication / contraindication**

The crib HANNAH is appropriate for the domestic care. The suitability of the equipment depends in each case on the symptoms and the physical/psychological condition of the patient and is to be judged by the qualified care staff and / or the treating therapist. Here it is to be mentioned that in particular the motor behaviour of the patient is to be considered in order to choose an appropriate accessory/variant selection. **The crib is not suited to transport of patient.**

## Description of functions

### **Moving the crib**

If you want to change the location of the crib and the crib is equipped with castors then please unlock the parking brakes at the castors. Please consider that the patient has to leave the crib while it is moved.

When moving the crib the power plug has to be pulled out of the plug socket and to be hung onto the mounting for mains cable at the end of the crib. Particularly make sure that the mains cable is not dragged along the ground and that it is not clamped.

After moving the crib to the desired position, the power plug has to be put back into the plug socket and the castors have to be locked again. Please make sure that the crib stands steady before the patient goes back into the crib.

**Attention!** The crib is not suited to transport of patient.

### **Handling of the doors**

The doors can only be opened from the outside. The left door in the middle has a two-handed door security locking system. To open the doors proceed as described:

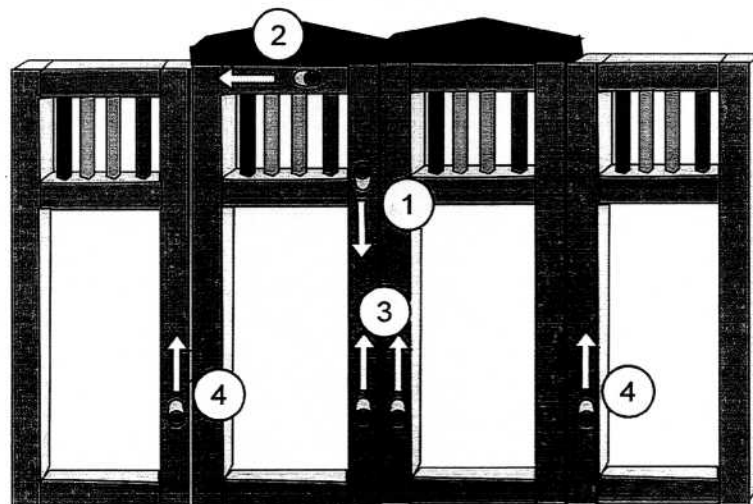

Opening the folding doors:

- Pull down fitting ① and hold it.
- Pull fitting ② with the other hand to the left and release fitting ①.
- To open the middle doors, pull fitting ③ upward.
- To open the outer doors, pull fitting ④ upward.

Closing the folding doors:

- Pull fitting ④ upward and close the outer doors as far as they will go and lock fitting ④ in place.
- Pull fitting ③ upward and close the middle doors as far as they will go and lock fitting ③ in place.
- In order to lock the doors in the middle make sure that the doors are exactly side by side.
- Pull down fitting ① and hold it.
- Pull fitting ② with the other hand to the right and release fitting ①.

Please consider that the side lattice can only offer protection against rolling out if the backrest and the mechanical foot adjustment are in the horizontal position (with adjustable lying surface). With unsupervised patients please lock the doors.

 **Attention!** For safety reasons we have chosen the operation force of the two-handed door security locking system with 50N higher than the general normative recommendations. This is for the security of the user and the patient.

## Accessories

1. Mattress – within delivery (except Great Britain)
2. 4 castors – additional equipment
3. Sleeping platform – within delivery
4. Patient lifter – additional equipment
5. Padding – additional equipment
6. Hoist for patient – additional equipment
7. All further accessories which are available on the market must be used only with an explicit written agreement of KayserBetten.

## Care and disinfection of the crib

**For cleaning** the crib all household cleaners without ammonia and scrubbing means are permissible.

**Attention:** Please wipe the crib with a damp cloth. Electric drives and manual control switches need to be protected against wetness. Mechanical cleaning or jet cleaning with steam or water is not permissible.

## Storage of the crib

1. Please do not accommodate the crib in free areas or areas with high air humidity.
2. Permissible values:

|              |            |
|--------------|------------|
| Air humidity | 20 %       |
| Temperature  | 0°C – 40°C |

## Maintenance

At least once a year the crib must be submitted maintenance. This must only be done by authorised and trained technical staff of the specialist dealer or the manufacturer. If there are any deviations from the requirements specified below, the crib has to be extracted from application for safety relevant reasons. Please fill out the attached maintenance form after any maintenance:

1. Accomplish a visual check of all existing parts of the crib soil (slatted frame). If you discover damages at these parts they have to be repaired or replaced immediately.  
Examine the operation smoothness of the hinges. If the hinges are „dry“ and if they give a noise, they are easily to grease with non-resinating fat or general-purpose oil.
2. Examine all locatings, screw connections, rivet joints and welding seams. No cracks or deformations must be present or construction units like e.g. nuts be missing.
3. Accomplish a visual check of the lifter (accessory) and the lifting bar. These must not show damages.
4. Accomplish a visual check of the wooden surround.
5. Examine the operation smoothness of the bolting devices of doors and side lattices.
6. Please check the side lattice under load (approx. 50kg) for its inherent stability. No gaps must arise > 125mm.
7. Examine the castors of the crib (if present) for their efficiency. Braking and driving function must be faultless.
8. Accomplish a visual and functional check of the drives. They are subjected to abrasion. If a strong heating is observed, high noise development, grinding or squeaking noises arise, if metal or plastic splinters are present at or under the motor, if the full adjustment range is not available anymore, the limit switches do not react or if the drives are slower than usual then the respective drive is damaged and must be exchanged immediately.
9. Examine the mains cables and the entire cable route for damages, breaks and rubbed positions and firmly defined route (intact cable attachments).

 **Attention:** In case that the mains cable or the power plug is damaged these parts must be replaced at once in order to avoid endangerments. The crib is to be extracted from application immediately after discovering a damage.

The manufacturer will put connection diagrams for a professional repair at the disposal of its customer service or authorised technical staff.

10. Examine the manual control switch and power supply unit for faultless function and outer damages.
11. The 9V-battery of the emergency sinking (power supply unit) has to be exchanged after 1 year of disuse.

Please check the crib regularly with each use for proper function. Please fix loosened connections instantly with appropriate tools. An objectionable product has to be extracted immediately from application and must be announced to the manufacturer or the responsible authorised specialist dealer.

### ***Disposal of the crib***

The crib must not be disposed into normal domestic refuse after the end of its life-span. Please return the crib to an authorised dealer or get in contact with a disposal company. The battery of the emergency sinking must be disposed to an appropriate collecting point.

## **Guarantee**

### **Attention:**

We issue a guarantee for new implements and their components purchased in the European Union which show a failure due to fabrication or material faults within 24 months after purchase.

This guarantee is not valid in case that the failure of the implement can be traced back to a faulty use and/or disregarding of the purpose and the behavioural rules described in these operating instructions. If you do not consider these operating instructions correctly, incorrect maintenance work as well as technical changes and additional constructions without agreement of KayserBetten lead to expiring of the warranty and the product liability in general.

### **Advice:**

Please give these instructions of the crib Hannah with the crib in case of a change in ownership.



## Explosion view

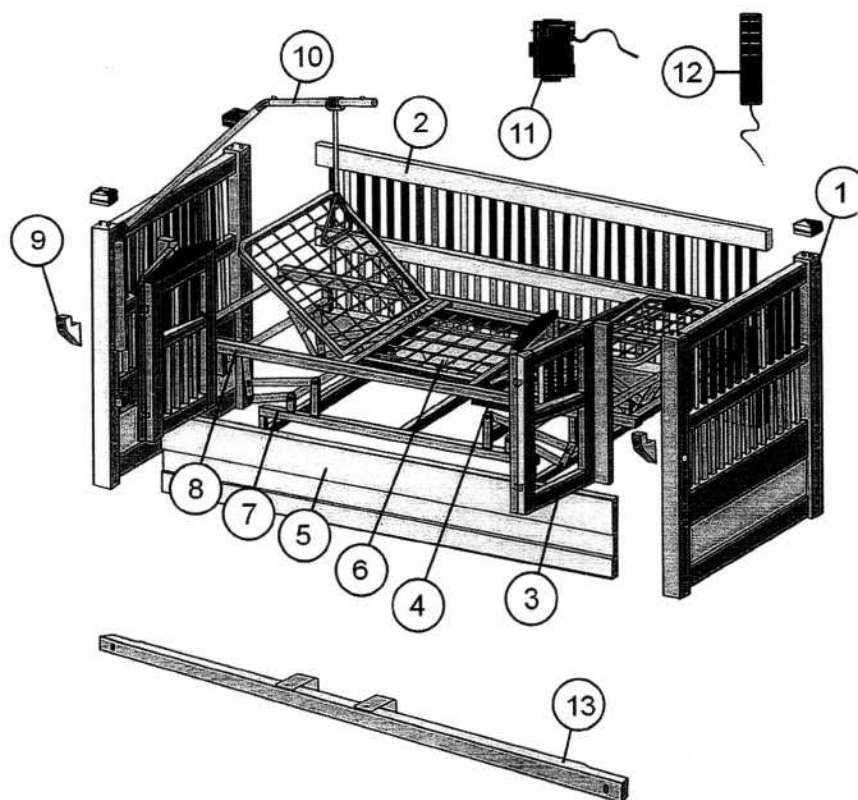

architrave 150mm

|    |  |
|----|--|
| 1  | side frame                             |
| 2  | back part                              |
| 3  | door                                   |
| 4  | drive for height adjustment            |
| 5  | frame connector                        |
| 6  | drive for backrest and foot adjustment |
| 7  | hoisting rack                          |
| 8  | sleeping platform                      |
| 9  | fastener for door safety bar           |
| 10 | lifter*                                |
| 11 | power supply unit                      |
| 12 | manual control switch                  |
| 13 | door safety bar                        |

\* optional

# Maintenance records first measurement KayserBetten due to VDE 0751

Records of first measurement before beginning of operation or after repair of electric components

Page 1 of 2

|                               |   |                                |                               |                                 |
|-------------------------------|---|--------------------------------|-------------------------------|---------------------------------|
| <b>Model</b>                  | Ida <input type="checkbox"/>  | Timmy <input type="checkbox"/> | Olaf <input type="checkbox"/> | Hannah <input type="checkbox"/> |
|                               | Series number   |                                |                               |                                 |
| <b>Reason for maintenance</b> | before beginning of operation <input type="checkbox"/> <span style="float: right;">after repair <input type="checkbox"/></span> |                                |                               |                                 |

|                  |       |
|------------------|-------|
| <b>Examinant</b> |       |
| Name             | Stamp |
| Place            |       |
| Date             |       |

|                                       |           |               |                   |
|---------------------------------------|-----------|---------------|-------------------|
| <b>Examination of electric safety</b> |           |               |                   |
| <b>Step of examination</b>            | <b>Is</b> | <b>Target</b> | <b>Assessment</b> |
| Insulating resistance                 |           | > 7 MOhm      |                   |
| Replacement device leakage current    |           | < 1 mA        |                   |
| Replacement patient leakage current   |           | < 5 mA        |                   |
| Residual current                      |           | < 3,5 mA      |                   |
| <b>Test control unit</b>              |           |               |                   |
| Manufacturer, Type                    |           |               |                   |

|                                       |                   |
|---------------------------------------|-------------------|
| <b>Examination of drives</b>          |                   |
| <b>Step of examination</b>            | <b>Assessment</b> |
| Mains cable undamaged?                |                   |
| Power plug undamaged?                 |                   |
| Strain relief functional?             |                   |
| Mounting for mains cable undamaged?   |                   |
| Motor- and control-housing undamaged? |                   |
| Mountings for drives undamaged?       |                   |

### Examination of adjustment functions

### Examination of the product information

Remarks

## Records of functional test and briefing

| Point of time | Name and signature of staff member authorised for briefing | Name and signature of briefed person responsible |
|---------------|--|--|
|               |  |  |
|               |  |  |
|               |  |  |
|               |  |  |
|               |  |  |
|               |  |  |

The briefing includes the demonstration of

- all electric adjustment functions including security switch box
- all operating elements (side lattices, wooden surround, etc.) and all connections which can be loosened without tools
- the lifter and its handling (if present)
- the basic function of moving and parking the crib
- the battery exchange at the drives as well as the reference to safety relevant aspects when using the crib

## Maintenance records KayserBetten due to VDE 0751

For examination please copy the records sheets, fill out the copy and archive it

Page 1 of 2

|                               |   |                                |                               |                                 |
|-------------------------------|---|--------------------------------|-------------------------------|---------------------------------|
| <b>Model</b>                  | Ida <input type="checkbox"/>  | Timmy <input type="checkbox"/> | Olaf <input type="checkbox"/> | Hannah <input type="checkbox"/> |
|                               | Series number: <input type="text"/>   |                                |                               |                                 |
| <b>Reason for maintenance</b> | beginning of operation <input type="checkbox"/> annual maintenance <input type="checkbox"/> after repair <input type="checkbox"/> |                                |                               |                                 |

|                  |       |
|------------------|-------|
| <b>Examinant</b> |       |
| Name             | Stamp |
| Place            |       |
| Date             |       |

|   |   |           |               |                   |
|---|---|-----------|---------------|-------------------|
| <b>Examination of electric safety</b>   |   |           |               |                   |
|   | <b>Step of examination</b>              | <b>Is</b> | <b>Target</b> | <b>Assessment</b> |
|   | Insulating resistance                   |           | > 7 MOhm      |                   |
|   | Replacement device leakage current      |           | < 1 mA        |                   |
|   | Replacement patient leakage current     |           | < 5 mA        |                   |
|   | Residual current                        |           | < 3,5 mA      |                   |
| In case that there is a significant discrepancy to the values of the first measurement, even if they comply with the target values, a further examination is necessary! |   |           |               |                   |
|   | <b>Test control unit</b>                |           |               |                   |
|   | Manufacturer, Type <input type="text"/> |           |               |                   |

|                              |                                       |                   |
|------------------------------|---------------------------------------|-------------------|
| <b>Examination of drives</b> |                                       |                   |
|                              | <b>Step of examination</b>            | <b>Assessment</b> |
|                              | Mains cable undamaged?                |                   |
|                              | Power plug undamaged?                 |                   |
|                              | Strain relief undamaged?              |                   |
|                              | Mounting for mains cable undamaged?   |                   |
|                              | Motor- and control-housing undamaged? |                   |
|                              | Mountings for drives undamaged?       |                   |

**Examination of general condition**

|  | <b>Step of examination</b>                                     | <b>Assessment</b> |
|--|--|-------------------|
|  | Wooden surround undamaged and fixed?                           |                   |
|  | Doors and crib sides can be lowered easily and with low noise? |                   |
|  | Device(s) functional?  |                   |
|  | Joining elements fixed and undamaged?                          |                   |
|  | Mounting of wooden surround undamaged and without abrasion?    |                   |
|  | Patient lifter undamaged (if present)?                         |                   |
|  | Patient lifter easily to move (if present)?                    |                   |
|  | Belt and lifter handle (triangle) undamaged?                   |                   |
|  | Castors allow quiet moving with little force?                  |                   |
|  | Castors are to brake?  |                   |

**Examination of adjustment functions**

|  | <b>Step of examination</b>                                       | <b>Assessment</b> |
|--|--|-------------------|
|  | Is the whole adjustment range of the sleeping platform possible? |                   |
|  | Do the drives switch off in the end positions?                   |                   |
|  | Do the buttons of the manual control switch react properly?      |                   |
|  | Are the adjustment functions quiet as usual?                     |                   |

**Examination of the product information**

|  | <b>Step of examination</b>                               | <b>Assessment</b> |
|--|--|-------------------|
|  | Type label on the wooden surround present and legible?   |                   |
|  | Type label on the drives present and legible?            |                   |
|  | Operating instruction for the crib present and complete? |                   |

**Remarks**

|  |
|--|
|  |
|--|