

TiLite TX

OPERATING &  
MAINTENANCE SUPPLEMENT



## Front Casters and Forks

(TX Series)

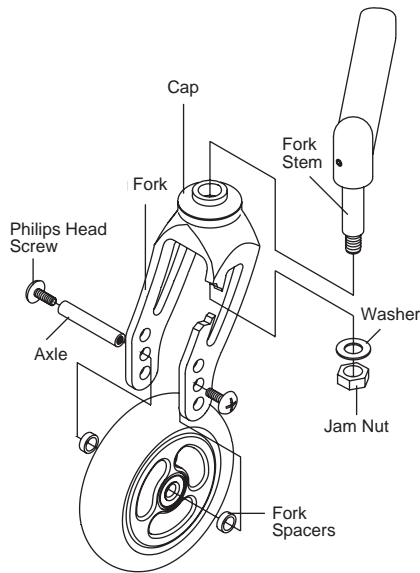

Figure 1  
TX Forks

### **WARNING**

Always mount identical size front casters and forks on both sides of your chair. *If you ignore this Warning, you may fall, tip over or lose control of the wheelchair and seriously injure yourself or others or damage the wheelchair.*

**Note:** The following instructions apply with respect to all 3", 4", 5" and 6" front casters. See Figure 1.

### Replacing Front Casters

Tools Needed:

- Two #2 Phillips Head Screw Drivers

1. Remove the two Phillips head screws and axle that secure the front caster to the fork. **Note:** It will be necessary to use one Phillips head screw driver to hold one screw in place and a second screw driver to loosen the other screw. See Figure 1.
2. Remove the front caster and fork spacers from the fork.
3. Install the new front caster and fork spacers onto the fork and securely tighten the two screws so there is no space between the front caster, the fork spacers and the fork sides. **Note:** It will be necessary to use one Phillips head screw driver to hold one screw in place in order to be able to securely tighten the other screw with the second screw driver.

### **WARNING**

The threads on the screws that secure the front casters to the fork have been treated with a medium strength thread lock to reduce the possibility that they will become loose. You should be able to remove and reinstall these screws two or three times without reapplying thread lock to these screws. If you repeatedly remove and reinstall these screws, TiLite requires that you reapply a medium-strength thread lock after every second adjustment.

### Replacing Front Forks

Tools Needed:

- 1/2" Socket Wrench

1. Remove the front casters. See "Replacing Front Casters" above.
2. Loosen and remove the jam nut and washer that secures the fork to the fork stem. See Figure 1.
3. Remove the old fork and install the replacement fork on the fork stem.
4. Replace the jam nut and washer and securely tighten.
5. Reinstall the front casters. See "Replacing Front Casters" above.

## Adjusting the Center of Gravity (TX Series)

### **WARNING**

When repositioning the camber clamps on the CG Bracket (as described below), always leave as many open holes between the two Allen Screws as your desired placement will permit. **NEVER** use two adjacent holes to attach the camber clamp to the CG Bracket. *If you ignore this Warning, your camber clamp may fail, causing you to fall, tip over or lose control of the chair and seriously injure yourself or others or damage the chair.*

#### Tools Needed:

- 3/16" Allen Wrench
- Ruler

1. Remove the rear wheels.
2. Remove the eight Allen Screws (four on each side of the chair) that secure the Camber Clamps to the CG Bracket. See Figure 2.
3. Reposition the Camber Clamps to the desired position on the CG Brackets, making absolutely sure the positioning is the same on both sides of the chair. You **MUST** leave one open hole between the two Allen Screws.
4. Reinstall the Allen Screws and lock washers and securely tighten all eight Allen Screws.
5. Reinstall the rear wheels.
6. Check the toe-in/toe-out and adjust as needed.

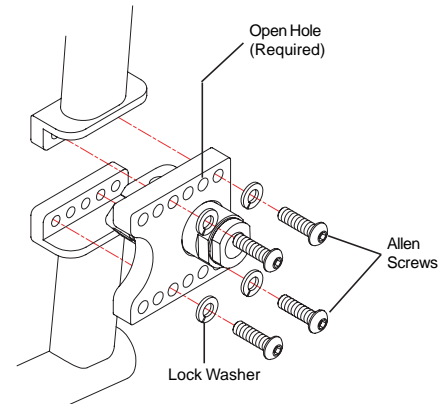

Figure 2  
Adjusting the Center of Gravity of the TX

## Replacing the Camber Plugs (TX Series)

### Tools Needed:

- 3/16" Allen Wrench
- Ruler

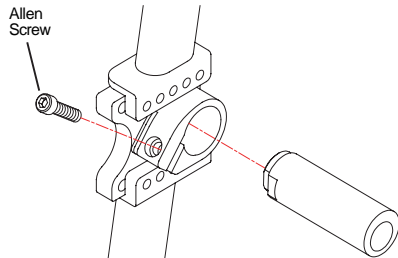

Figure 3  
Replacing the Camber Plug on TX

1. Remove the rear wheels.
2. Loosen, but do not remove, the Allen Screw that secures the camber plugs to each camber clamp. See Figure 3.
3. Remove the camber plugs.
4. Install the new camber plugs, making sure the distance from the outside edge of the camber clamp to the end of the camber plug is identical on each side of the chair.
5. Securely tighten the Allen Screw.
6. Reinstall the rear wheels.
7. Check the toe-in/toe-out and adjust as needed.

## Tension Adjustable Slide-in Seat Sling (TX Series)

### **WARNING**

Do not make the seat sling upholstery tension so loose that it does not properly support your weight. The sling should never be so loose that the sling causes your weight to be borne by the cross-tubes below the seat sling.

### Adjusting the Tension

Tools required:

- Flat Head Screw Driver

1. Remove the seat cushion and the seat rail cap. Fold TX. See figure 4.
2. Remove slide in seat sling and rod. See Figure 5.
3. Detach the Velcro adjustment flap and adjust the seat upholstery to the desired tension.
4. Re-insert slide in seat rail and rod.
5. Unfold TX. Reattach the seat rail cap and replace the seat cushion.

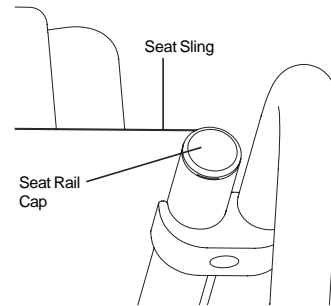

Figure 4  
Remove Slide in Seat Sling

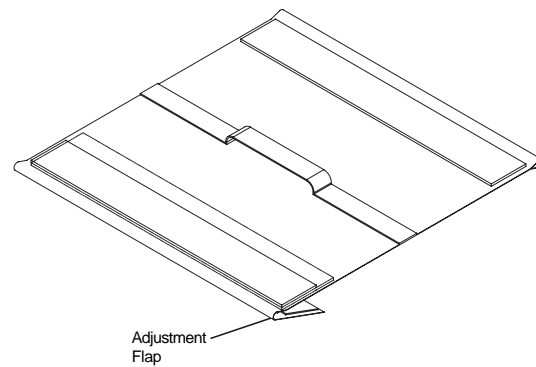

Figure 5  
Adjusting Tension of Slide in Seat Sling

# FOOTREST ADJUSTMENT AND REPLACEMENT

(TX Series)

## Adjusting the Height of the Footrest

### Tools Needed:

- 5/32" Allen Wrench
- Ruler

1. Loosen the two Allen Screws in the left clamp that secures the footrest to the frame. See Figure 6. Loosen each Allen Screw until the entire head of the screw is completely visible outside the clamp.
2. Place the end of a ruler on the floor and hold it vertically against the corner of the footrest. See Figure 7. Adjust the left side of the footrest to the desired height (not less than 2" of ground clearance) and tighten the Allen Screws in the left clamp so the left footrest cannot change.
4. Repeat the procedure from step 1 and 2 above on the right footrest.
5. When both sides are set, fully tighten the two Allen Screws in each clamp that secures the footrests to the chair frame, making sure the clamp remains securely butted up against the end of the frame tube.

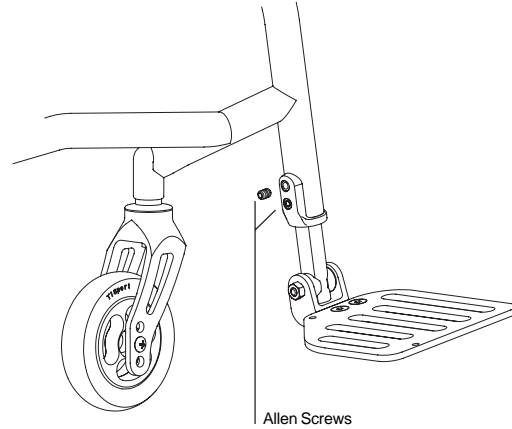

Figure 6  
TX Footrest Replacement

## Replacing the Footrest

### Tools Needed:

- 5/32" Allen Wrench
- Ruler

1. Loosen the Allen Screws in the two clamps that secure the footrest to the frame. See Figure 6. Loosen each Allen Screw until the entire head of the screw is completely visible outside the clamp.
2. Remove the footrest.
3. Insert the new footrest into the clamp and, holding the wedge in place against the clamp, partially screw the Allen Screw into the clamp and the wedge.
4. Slide the clamp into the frame tube until the clamp is securely butted against the end of the frame tube. Fully tighten the Allen Screws.
5. Place the end of a ruler on the floor and hold it vertically against the left corner of the footrest. See Figure 7. Adjust the left side of the footrest to the desired height (not less than 2" of ground clearance) and tighten the Allen Screw in the left clamp so the left side of the footrest cannot change.
6. Repeat the procedure from step 5 above on the right side of the footrest.
7. When both sides are set, fully tighten the two Allen Screws in each clamp that secures both footrests to the chair frame, making sure the clamp remains securely butted up against the end of the frame tube.

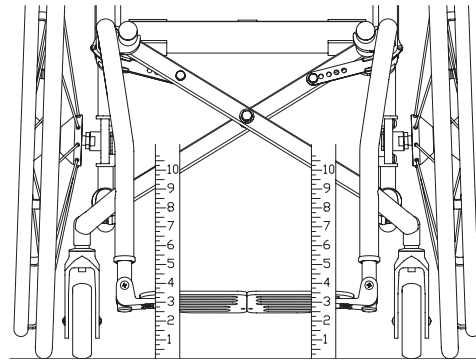

Figure 7  
TX Footrest Height Adjustment



THE TITANIUM EXPERTS.™

1426 East Third Avenue Kennewick, Washington 99337

800.545.2266 Toll-Free | 509.586.6117 Telephone

800.586.2413 Toll-Free Facsimile | 509.586.2413 Facsimile

[www.tilite.com](http://www.tilite.com)