

SilverStar[™]

BACKPACKER PLUS



OWNER'S MANUAL

SAFETY GUIDELINES



WARNING! An authorized Pride Provider or qualified technician must perform the initial setup of this lift and must perform all of the instructions in this manual.

The symbols below are used throughout this owner's manual and on the product to identify warnings and important information. It is very important for you to read them and understand them completely.



WARNING! Indicates a potentially hazardous condition/situation. Failure to follow designated procedures can cause either personal injury, component damage, or malfunction. On the product, this icon is represented as a black symbol on a yellow triangle with a black border.



MANDATORY! These actions should be performed as specified. Failure to perform mandatory actions can cause personal injury and/or equipment damage. On the product, this icon is represented as a white symbol on a blue dot with a white border.



PROHIBITED! These actions are prohibited. These actions should not be performed at any time or in any circumstances. Performing a prohibited action can cause personal injury and/or equipment damage. On the product, this icon is represented as a black symbol with a red circle and red slash.

Please fill out the following information for quick reference:

Pride Provider: _____	
Address: _____	
Phone Number: _____	
Purchase Date: _____	Serial Number: _____

NOTE: This owner's manual is compiled from the latest specifications and product information available at the time of publication. We reserve the right to make changes as they become necessary. Any changes to our products may cause slight variations between the illustrations and explanations in this manual and the product you have purchased. The latest/current version of this manual is available on our website.

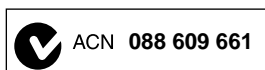

CONTENTS

I. INTRODUCTION	4
II. SAFETY	5
III. INSTALLATION	8
IV. OPERATION	13
V. BATTERY CHARGING	15
VI. CARE AND MAINTENANCE	17
VII. TROUBLESHOOTING	19
VIII. SPECIFICATIONS	20
IX. WARRANTY	21

I . I N T R O D U C T I O N

Welcome to Pride Mobility Products Corporation (Pride). Congratulations on the purchase of your new Backpacker Plus Lift System. The Backpacker Plus Lift System design combines the most advanced state-of-the-art components with modern, attractive styling. We are certain that the design features and trouble-free operation will add convenience to your daily living and ensure complete satisfaction.

At Pride, your safety is important to us. **Please read and follow all instructions in this manual before operating your lift system for the first time.** These instructions were produced for your benefit. Your understanding of these instructions is essential for the safe operation of your new lift system.

Pride is not liable for damage to property or personal injury arising out of the unsafe use of a Backpacker Plus Lift System. Pride is also not liable for any property damage or personal injury arising out of the failure of any person and/or user to follow the instructions and recommendations set forth in this manual or any other instructions or recommendations contained in other Backpacker Plus Lift System related literature issued by Pride or contained on the Backpacker Plus Lift System itself.

INTERNET AND PRIVATE PURCHASES

If you purchased your product over the Internet or from a previous owner and you have any questions about the safe use and/or maintenance of the product, please visit Pride's web site **www.pridemobility.com** or contact your authorized Pride Provider.

PURCHASER'S AGREEMENT

By accepting delivery of this product, you promise that you will not change, alter, or modify this product or remove or render inoperable or unsafe any guards, shields, or other safety features of this product; fail, refuse, or neglect to install any retrofit kits from time to time provided by Pride to enhance or preserve the safe use of this product.

SHIPPING AND DELIVERY

Before using your product, make sure your delivery is complete as some components may be individually packaged. If you do not receive a complete delivery, please contact your authorized Pride Provider immediately. Where damage has occurred during transport, either to the packaging or content, please contact the delivery company responsible.

Please notify us of any change of address, so we can keep you apprised of important information about safety, new products, and new options that can increase your ability to use and enjoy your new lift system. Please feel free to contact us at the address below:

Pride Mobility Products Corporation
Attn.: Customer Care Department
182 Susquehanna Ave.
Exeter, PA 18643-2694

customercare@pridemobility.com
1-800.424.8205

NOTE: If you ever lose or misplace your product registration card or your copy of this manual, contact us and we will be glad to send you a new one immediately.

II. SAFETY

PRODUCT SAFETY SYMBOLS

The symbols below are used on the lift system to identify warnings, mandatory actions, and prohibited actions. It is very important for you to read and understand them completely.

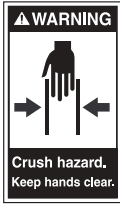

Crush Hazard—Pinch/crush points created during assembly and operation. Keep hands clear.



Crush Hazard—Moving parts can crush and cut. Keep hands clear.



Crush Hazard—Moving lift can crush. Keep feet clear during operation.



Do not sit on mobility device while activating lift or during transport.



Read and follow the information in the owner's manual.



Maximum lifting capacity.



Do not use as a step.



Lift system intended for use with unoccupied mobility device. Do not use product to lift people.



Removal of grounding prong can create electrical hazard. If necessary, properly install an approved 3-pronged adapter to an electrical outlet having 2-pronged plug access.



Do not connect an extension cord to the charger cord.

II. SAFETY



Avoid exposure to rain, snow, ice, salt, or standing water whenever possible. Maintain and store in a clean and dry condition.

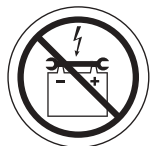

Contact with tools can cause electrical shock.



Do not allow unsupervised children to play near the lift while the batteries are charging.



Corrosive chemicals contained in battery.



Explosive conditions exist!



Use only AGM or Gel-Cell batteries to reduce the risk of leakage or explosive conditions.



Contains Lead.



Wear safety goggles.



Disposal and recycling-Contact your authorized Pride Provider for information on proper disposal of your Pride product and its packaging.



II. SAFETY

LIFTING CAPABILITIES

The Backpacker Plus Lift System is designed for a maximum lifting capacity of 325 lbs. (147 kg). Under no circumstances should the Backpacker Plus Lift System be made to exceed this weight limit. Subjecting the lift system to the strain of lifting more than it is designed to may cause it to fail, resulting in damage to the mobility device and/or the lift operator. Refer to the mobility device owner's manual for information on the overall weight of the mobility device before lifting.



WARNING! Adding accessories, oversize batteries, or a different seat will increase the weight of your mobility device. Verify with your authorized Pride Provider that the total weight of your mobility device, including additions, does not exceed 325 lbs. (147 kg).

INSTALLATION

Your Backpacker Plus Lift System is an inside vehicle lift designed for installation into various brands of full-sized and mini-vans and sport utility vehicles. Read and fully understand the installation instructions provided in this manual and related literature for your brand of vehicle before installing the lift system.

LIFTING NON-PRIDE DEVICES

The Backpacker Plus Lift System is an extremely versatile product which users may employ to lift items other than Pride products. Pride has no control over such use, nor can Pride anticipate every possible use to which a Backpacker Plus Lift System may be put. Lifting non-Pride products with the Backpacker Plus Lift System is done at the operator's own risk, and Pride accepts no liability for damage or injury resulting from such use.

PRELIFT INSPECTION

Before operating the Backpacker Plus Lift System, conduct a careful survey of your surroundings to ensure that the lift system has a clear path of operation. Remove any possible obstructions before operating the lift and do not allow children to operate or play near the lift. Ensure that all parts of the lift system are completely fastened before loading the mobility device onto the lift platform, and make sure the mobility device is properly secured before operating the lift system.

OPERATOR POSITIONING

The operator of the lift should stand a safe distance from the unit being lifted/lowered to ensure that his/her feet are never positioned under the raised lift platform. The operator should also keep his/her hands clear of the lift system during operation.

TRANSPORT VEHICLE POSITIONING

Be sure your vehicle is parked on flat, level ground before attempting to load, lift, or remove a mobility device with the Backpacker Plus Lift System. Make sure the vehicle emergency park brake is engaged before loading or unloading a mobility device.

III. INSTALLATION

BACKPACKER PLUS LIFT SYSTEM INSTALLATION



WARNING! The Backpacker Plus Lift should be installed by an authorized service technician only.

NOTE: Use only the supplied hardware to install the Backpacker Plus Lift System.

Follow these steps to install the Backpacker Plus:

1. Remove the rear seat from the vehicle according to the vehicle manufacturer's removal instructions.
2. Route the Backpacker Plus wiring harness through the vehicle. See "Wiring Harness Installation."



WARNING! Route the wiring harness through the vehicle rather than under the vehicle to avoid coming in contact with sharp edges, extreme temperatures, moving parts, and roadway debris. Power shorts may occur if wires come in contact with hot exhaust parts or sharp edges.

WARNING! Never attach the wiring harness to a secondary power source. Do not attempt to use trailer wiring to power the lift system. The wiring harness must be connected directly to the vehicle's battery.

NOTE: If your lift is equipped with an optional onboard battery, refer to "Onboard Battery Installation."

3. Position a securement system floor plate over each set of floor locks that hold the rear seat to the floor of the vehicle. See figure 1.

NOTE: Securement systems vary depending on vehicle manufacturer. While these instructions describe basic installation for most vehicles, your securement system may require separate parts based on the make of your vehicle. Refer to the installation instructions supplied with your securement system or contact your authorized Pride Provider for more information.

4. Secure each floor plate to the floor of the vehicle using the supplied mounting hardware. See figure 1. Do not fully tighten the mounting hardware at this time.
5. Position the mid-riser bar over the floor plate closest to the rear of the vehicle, aligning the mounting holes in the mid-riser bar with those in the floor plate. See figure 1.
6. Connect the Backpacker Plus wiring harness to the hand control.
7. Place the Backpacker Plus up on blocks, so that there is at least 1 ft. (0.3 meter) of clearance under the frame.

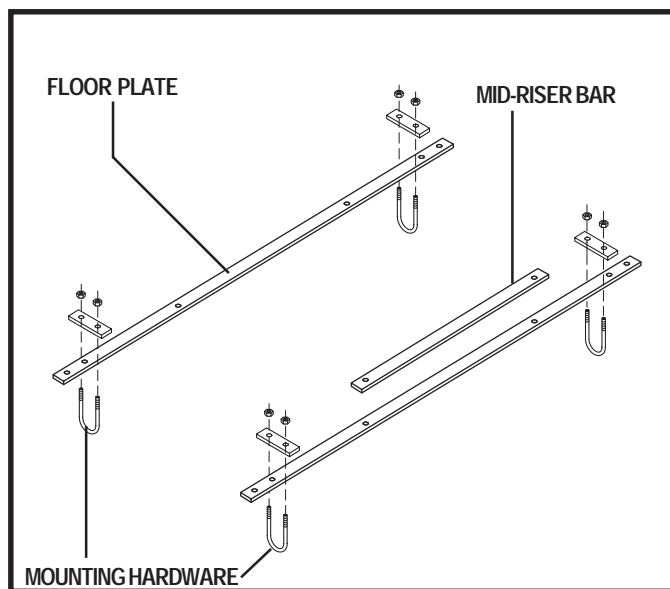

Figure 1. Basic Securement System Installation

III. INSTALLATION

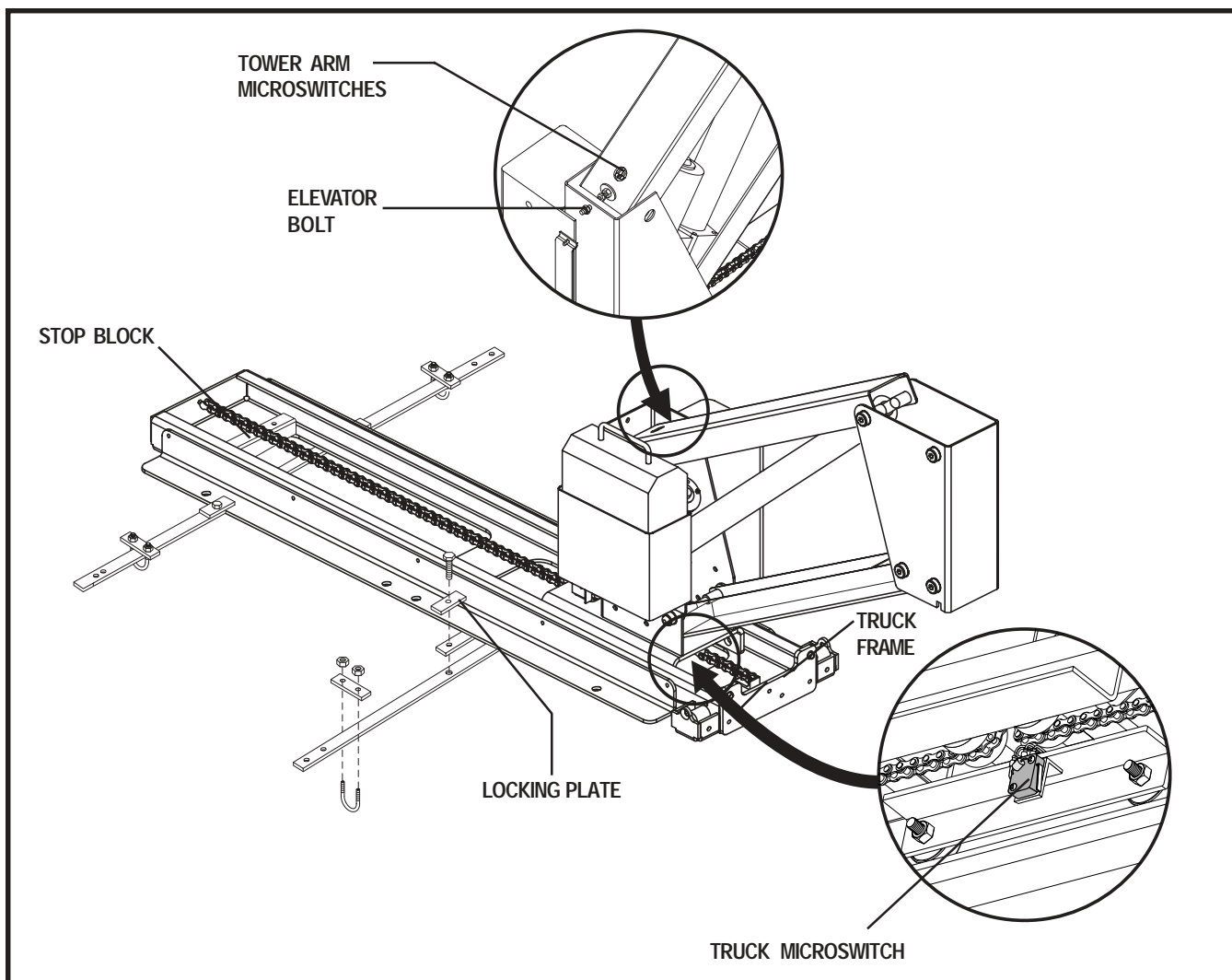

Figure 2. Backpacker Plus Installation

8. Connect the Backpacker Plus to a power source.
9. Reach under the Backpacker Plus truck frame and simultaneously press the microswitch and the “UP” button on the hand control to raise the tower 4-6 in. (10-15 cm). See figure 2.
10. Carefully slide the Backpacker Plus into the rear of the vehicle and center it over the threaded holes in the floor plates. Make sure the mid-riser bar is still properly aligned.



WARNING! At least two people should lift the Backpacker Plus into the rear of the vehicle. Use proper lifting techniques and avoid lifting beyond your physical capability.

WARNING! Avoid pinch points! Do not hold the lift frame by the pivot points when installing the Backpacker Plus.

11. Place a locking plate over each of the threaded holes in the floor plate and secure with the supplied bolts. Screw the bolts into the threaded holes, but do not fully tighten the hardware at this time. See figure 2.
12. Simultaneously press the two microswitches on the Backpacker Plus tower arm and the “DOWN” button on the hand control until the tower reaches its full extension. See figure 2.
13. Release the microswitches, then press the “UP” button on the hand control to retract the tower arm.

III. INSTALLATION

14. Flip the T-bar into an upright position. Insert the T-bar into the lift tower and secure into position with the supplied hardware. See figure 3.
15. Push the “UP” button on the hand control to raise the platform frame to its highest position.
16. Inspect the clearance between the bumper and the platform frame. Appropriate clearance is necessary in order to slide the platform into the vehicle.

NOTE: *If there is not adequate clearance between the bumper and the platform frame, you may need to install an end support bracket. Remove the Backpacker Plus from the vehicle and install the end support bracket close to the rear door opening. Reinstall the lift into the vehicle, making sure that the bolts protruding from the bottom plate of the Backpacker Plus closest to the vehicle door snap into the tapped holes on the top of the end support bracket, then repeat steps 13 through 16.*

NOTE: *It may be required to trim the rear inside sill to achieve the adequate platform clearance with the platform under load.*

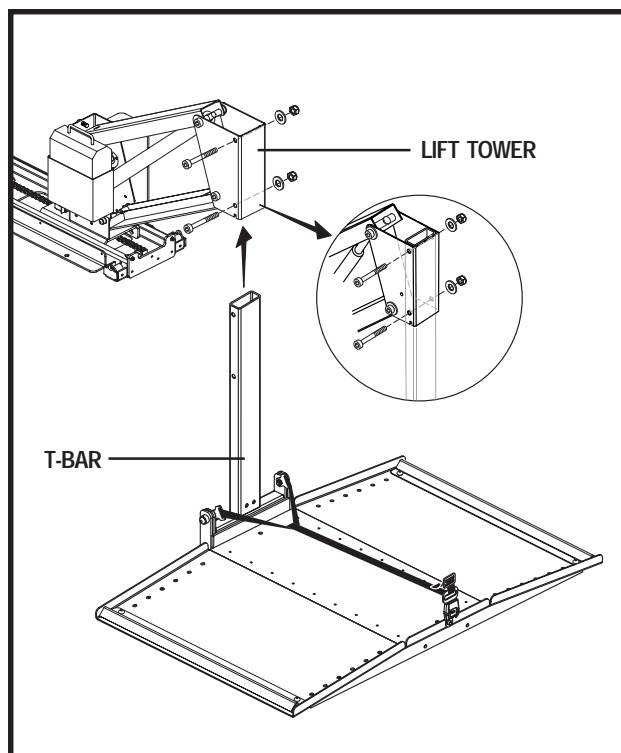

Figure 3. T-Bar Installation

17. Fully tighten all mounting hardware throughout the lift system once the unit has been centered and all required clearances have been achieved.
18. Run the Backpacker Plus through an entire lift cycle. Lower the platform to the ground and then raise the platform to the fully stowed position in the vehicle. See IV. “Operation.”

NOTE: *Pay attention to the path of the lift platform during operation. Make sure the lift does not rub against or interfere with the vehicle in any way. If you notice any contact between the lift platform and the vehicle, stop lift operation immediately and contact your authorized Pride Provider for assistance.*



WARNING! Release the “DOWN” button when the lift platform touches the ground. Do not allow the motor to run after the lift platform has touched the ground. Allowing the motor to run will increase the pressure on the lift platform and may result in product or vehicle damage.

Elevator Bolt Adjustment

Once the Backpacker Plus is properly installed, it will need to be adjusted for proper weight distribution using the elevator bolt located on the lift frame. See figure 2. The elevator bolt adjustment must be made using the mobility device that will be lifted.

Follow these steps to adjust the elevator bolt:

1. Loosen the elevator bolt so it will not contact the microswitches when the tower is raised.
2. Raise the tower until it clutches.
3. Adjust the elevator bolt to contact the switches.

III. INSTALLATION

Wiring Harness Installation

The wiring harness is approximately 25 ft. (7.62 meters) long and will accommodate most vehicles.

NOTE: You may wish to perform a practice run before installing the wiring harness. Route a piece of light rope (equivalent to the gage of the wiring harness) along the anticipated path observing contact points, potential rubbing/chafing points, and any sharp edges. Remove sharp edges with a fine grade file, then treat the steel with a rust inhibitor or metal sealant.

Follow these steps to route the Backpacker Plus wiring harness:

1. Route the lift system wiring harness (starting at the lift) through the interior of the vehicle until you reach the vehicle battery. See figure 4.



WARNING! Avoid routing the wire harness where it will interfere with or become pinched by the securement system floor plates.

2. Conceal the harness behind or under the interior panels (there should be existing holes). Be certain that the harness is protected with a rubber grommet when passing it through the metal panels and into the engine compartment.
3. Inside the engine compartment, secure the harness to the firewall and the inner fender with plastic wire ties. Use care not to cause abrasions to the wiring harness. It is important to secure the wiring harness at various points along its run of the vehicle.



WARNING! Do not cut or shorten the wiring harness. If the harness is too long, coil the excess wire and secure it with plastic wire ties.

4. Remove the 15-amp fuse from the wiring harness. See figure 4.
5. Connect the red wire to the positive (+) terminal and the black (grounding) wire to the negative (-) terminal of the vehicle battery.
6. Reinstall the 15-amp fuse to the wiring harness.



WARNING! Before operating the lift, inspect the wiring harness for proper routing and grounding. Improper routing can cause damage to the harness, and improper grounding can cause damage to the electrical system.

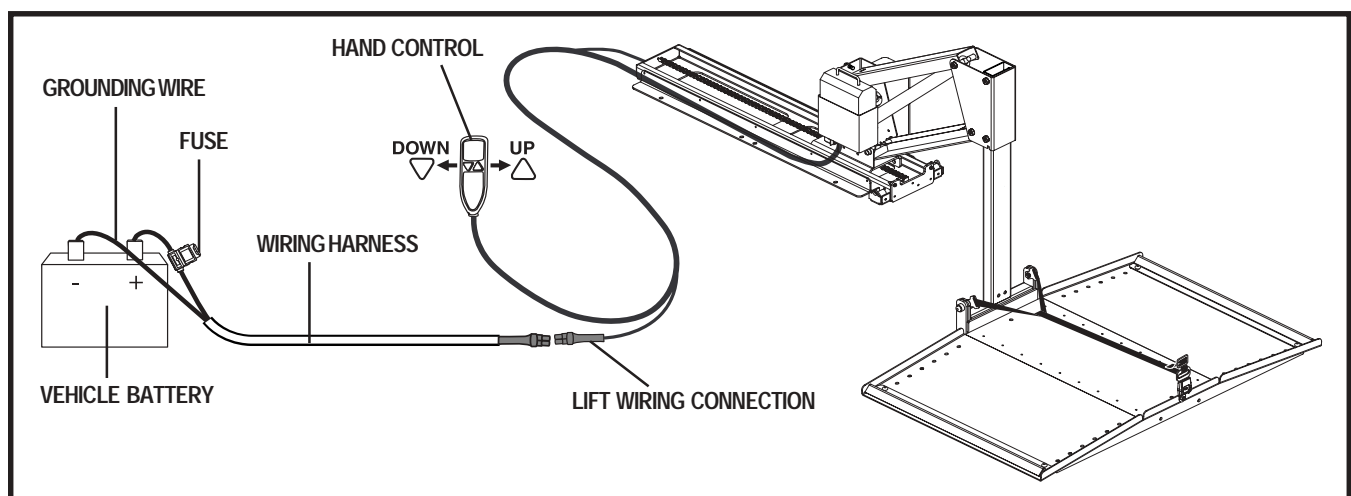

Figure 4. Wiring Harness Installation

III. INSTALLATION

Onboard Battery Installation

The optional onboard battery is designed for easy installation as it does not require any wires to be routed through or under the vehicle.

Follow these steps to install the onboard battery:

1. Remove the rubber caps and nuts from the protruding bolts on the side of the lift motor housing. See figure 5.
2. Mount the battery case onto the protruding bolts and secure into position with the nuts removed earlier. See figure 5.
3. Insert the onboard battery into the battery case, making sure that the connector on the bottom of the battery aligns and fully connects with the mating connector inside the battery case.
4. Connect the male connector on the battery cable to the female connector at the base of the Backpacker Plus.
5. Secure the battery cable to the other cables with wire ties.

Wheel Chock Installation

Your lift is supplied with two adjustable wheel chocks which, when installed, aid in centering your mobility device during loading. See figure 6.

Follow these steps to install the wheel chocks:

1. Drive your mobility device onto the lift platform, positioning it as near to the center as possible.
2. Position the wheel chocks on the platform.

Scooters: Place a wheel chock in front of the front wheel(s) and behind the rear wheels.

Power chairs: Place a wheel chock in front of the drive wheels and behind the rear casters.

Take note of the adjustment holes the wheel chocks align with on the platform and remove the chocks.

NOTE: For larger scooters, the wheel chocks may be positioned to the inside of each wheel.

3. Remove the mobility device from the lift platform.
4. Raise the platform high enough to be able to install hardware from beneath it.
5. Place the wheel chocks onto the lift platform and secure them with the supplied bolts and nuts.

NOTE: Make sure the mobility device is properly secured with the Y-strap before operating the lift or transporting the mobility device.

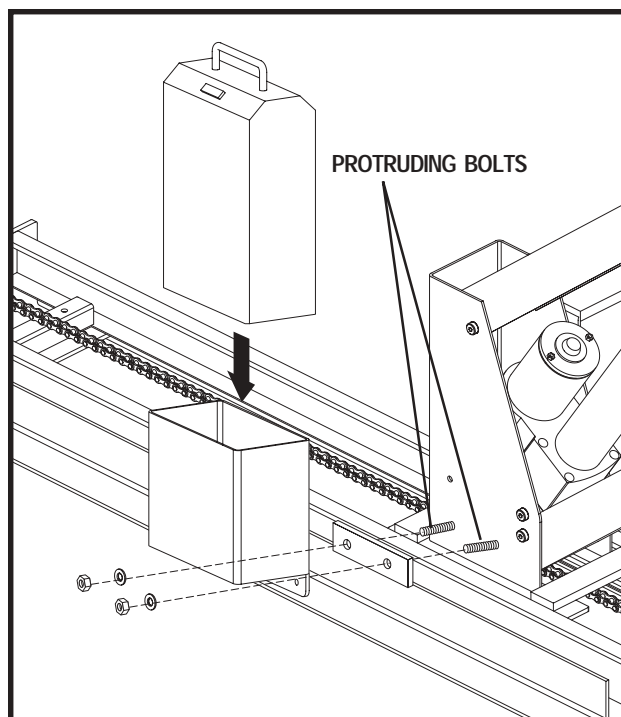

Figure 5. Onboard Battery Installation

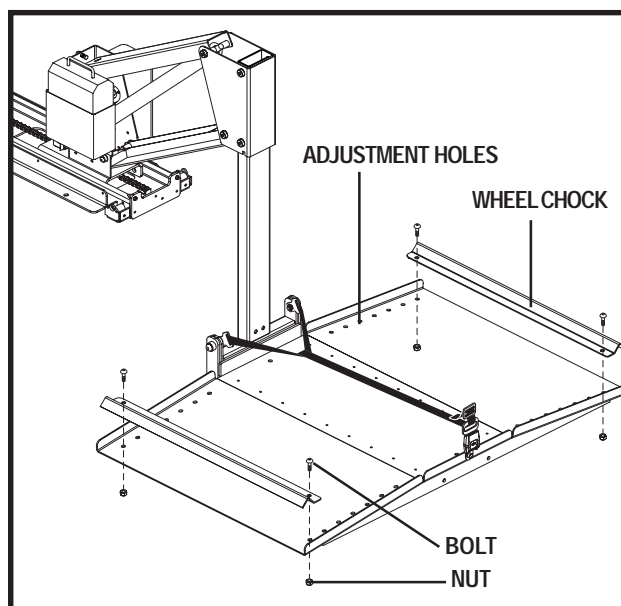

Figure 6. Wheel Chock Installation

IV. OPERATION

BACKPACKER PLUS LIFT SYSTEM OPERATION

The Backpacker Plus Lift System is designed to lift an unoccupied mobility device from the ground and into the cargo area of a motor vehicle for the purpose of easy transport.



WARNING! The Backpacker Plus Lift System is intended for the transport of unoccupied mobility devices only. Do not sit on mobility device while activating lift or during transport.



WARNING! Make sure the lift system is clean, dry, and free of obstructions before operating.

Follow these steps to load a mobility device with the Backpacker Plus Lift System:

1. Press and hold the “DOWN” button. See figure 7. The lift will move out of the vehicle to its farthest forward stop, then lower to the ground. Once the platform has reached the ground, release the “DOWN” button.



WARNING! Release the “DOWN” button when the lift platform touches the ground. Do not allow the motor to run after the lift platform has touched the ground. Allowing the motor to run will increase the pressure on the lift platform and may result in product or vehicle damage.

NOTE: The lift motor is equipped with a slip clutch, which emits a ratcheting noise at the end of each horizontal (in and out) movement. This sound is normal and does not indicate a problem with your lift system.



WARNING! Maintain a safe distance from the lift platform. Ensure your feet are not positioned under the lift platform and keep your hands clear of the lift system during operation.

2. Set the speed control to the slowest setting and carefully drive the mobility device onto the lift platform, being sure to center the mobility device between the previously installed wheel chocks.

NOTE: You may wish to load the mobility device while standing next to it using the manual freewheel feature. Refer to the mobility device owner’s manual for more information on manual freewheel mode.

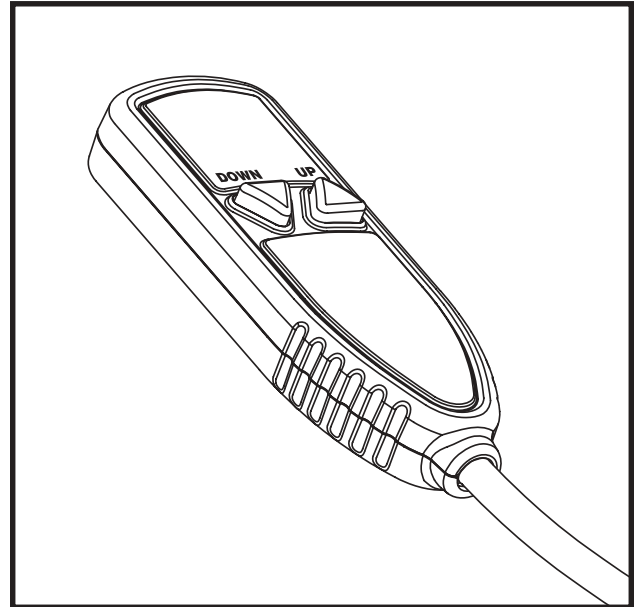

Figure 7. Hand Control

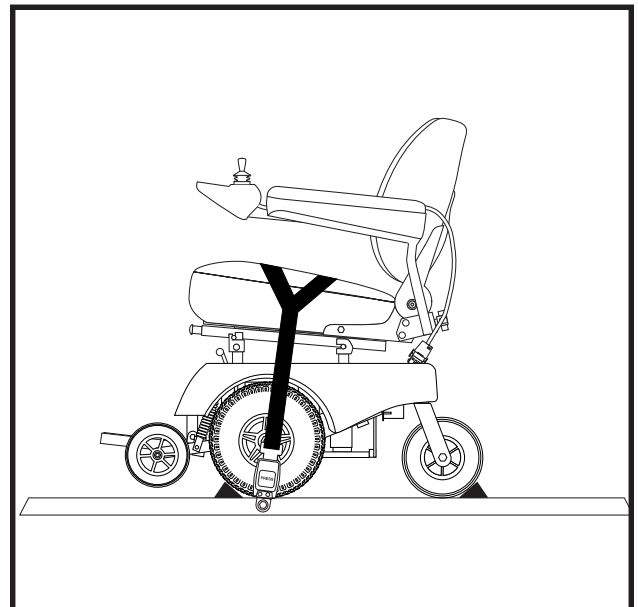

Figure 8. Y-Strap Positioning

IV. OPERATION

3. Shut down the power to the mobility device, remove the key if applicable, and make sure the unit is in drive mode (drive motors engaged). Refer to the mobility device owner's manual for more information on drive mode.



WARNING! Never leave a mobility device in freewheel mode during lift system transport, as the mobility device could roll or shift on its own.

4. Secure the mobility device to the platform by draping the Y-strap over the seat and buckling the strap securely. See figure 8.



WARNING! Never attempt to secure the Y-strap over the seatback or armrests of the mobility device.



MANDATORY! Always secure the mobility device to the lift with the Y-strap before lift system operation or vehicle transport.

5. Pull the end of the Y-strap tightly to remove any excess slack over the seat.

NOTE: Inspect the Y-strap before each use to ensure there are no signs of fraying or wear. Ensure that the mobility device is secured properly before transport. Pride is not liable for damage or loss resulting from improper securement of a mobility device.

6. Press and hold the "UP" button. See figure 7. The lift will move up to its highest lift point, then slide into the vehicle. Once the mobility device is stowed completely within the vehicle, release the button.

NOTE: Make sure that the vehicle has enough "head room" to accommodate the height of the mobility device before loading it into the vehicle. Lower the tiller, adjust the seatback angle, or remove the seat if necessary. Refer to the mobility device owner's manual for more information on these adjustments.



WARNING! Do not exceed the load limits of your vehicle as specified by the vehicle's manufacturer.

WARNING! Do not sit on your mobility device while it is in a moving vehicle.

When you are ready to remove the mobility device from the vehicle, lower the platform to the ground, unfasten the Y-strap, and drive the mobility device off of the platform. Once unloading is complete, return the lift platform into the vehicle.

V. BATTERY CHARGING

BATTERY CHARGING

Follow these steps to charge the onboard battery:

1. Remove the onboard battery from the battery case and place it near a standard electrical wall outlet.
2. Remove the cap from the charger socket located on the bottom of the battery, plug the charger cord into the charger socket, then connect the charger cord to a standard electrical outlet. See figure 9.



MANDATORY! Read the battery charging instructions in this manual and in the manual supplied with the battery charger before charging the battery.



PROHIBITED! Never use an extension cord to plug in your charger cord. Plug the charger cord directly into a properly wired standard wall outlet.



PROHIBITED! Removal of the grounding prong can create an electrical hazard. If necessary, properly install an approved 3-pronged adapter to an electrical outlet having 2-pronged plug access.



PROHIBITED! Do not allow unsupervised children to play near the battery pack while the battery is charging.



WARNING! Explosive gases may be generated while charging the battery. Keep the battery charger away from sources of ignition such as flames or sparks and provide adequate ventilation when charging the battery.

WARNING! Do not attempt to charge the battery and operate the lift system at the same time.

WARNING! Do not attempt to wire the lift system directly to the vehicle battery if the lift system is equipped with an onboard battery.



WARNING! You must recharge the lift system battery with the supplied battery charger.

WARNING! Always protect the battery from freezing and never charge a frozen battery.

NOTE: It is recommended that you replace the battery every 3–5 years. Store the battery in a moisture-free environment when not in use.

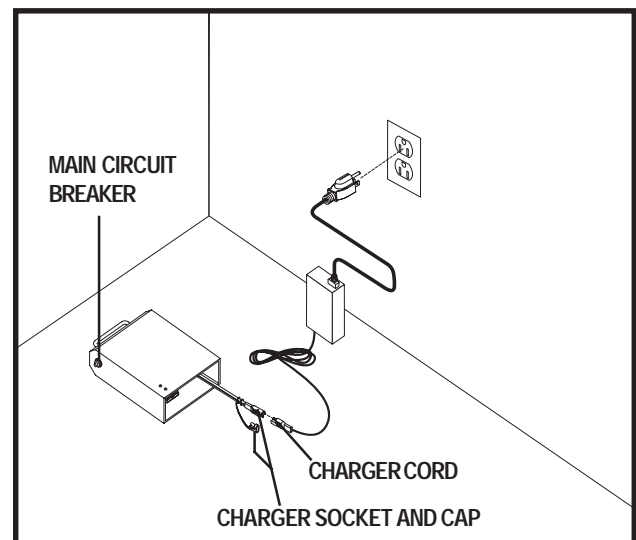

Figure 9. Battery Charging

V. BATTERY CHARGING

Charger Circuit Fuse

The battery charger cord is equipped with a 7.5A charger circuit fuse. In the event the fuse should cease to work:

1. Remove the cap from the fuse holder, then pull the fuse out of its slot.
2. Examine the fuse to be sure it is blown. See figure 10.
3. Insert a new fuse of the same rating.

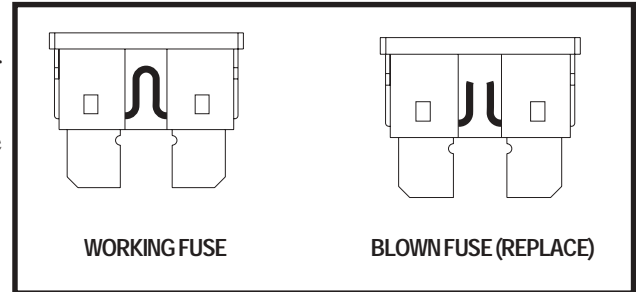

Figure 10. Fuse Replacement



WARNING! The replacement fuse must exactly match the rating of the fuse being replaced. Failure to use properly rated fuses may cause damage to the electrical system.

Main Circuit Breaker

The main circuit breaker is a safety feature built into your lift system's battery. See figure 9. When the battery and/or motor is heavily strained (e.g., from excessive loads), the main circuit breaker trips to prevent damage to the motor and the electronics. If the circuit trips, allow the lift system to “rest” for approximately one minute. Then, push in the circuit breaker button and continue normal operation. If the main circuit breaker continues to trip repeatedly, contact your authorized Pride Provider.

V I . C A R E A N D M A I N T E N A N C E

CARE AND MAINTENANCE

Your lift system requires a minimal amount of care and maintenance. If you do not feel confident in your ability to perform the maintenance listed below, you may schedule inspection and maintenance at your authorized Pride Provider. The following areas require periodic inspection and/or care and maintenance.

90-Day Maintenance Schedule

Every 90 days, remove the battery connections and clean them to ensure uninterrupted electronic connection. In addition, grease these pivot points:

- Chain
- Pivot Bolts on Parallel Arms
- Truck Drive Shaft

Wiring Harness and Hand Control

- The wiring harness should be checked periodically for corrosion and/or decay. Contact your authorized Pride Provider if the wiring harness needs to be replaced.
- Avoid leaving the hand control in areas where it will be exposed to inclement weather or temperature extremes. Exposure to the elements may cause damage to the hand control.



WARNING! Avoid exposure to rain, snow, ice, salt, or standing water whenever possible. Maintain and store in a clean and dry condition.

Lift Platform/Metal Components

- Check the lift platform for wear or damage. Contact your authorized Pride Provider for repair or replacement.
- The lift platform surface may become slippery if exposed to moisture (ice, snow, rain, mist/spray conditions, etc.). Use caution when loading/unloading a mobility device in these conditions and wipe off any excess moisture from the lift platform.
- Regularly inspect the metal lift components for scratches. Treat any problem areas with a rust inhibitor or metal sealant.

Battery Replacement



MANDATORY! Battery posts, terminals, and related accessories contain lead and lead compounds. Wear goggles and gloves when handling batteries and wash hands after handling.



MANDATORY! Use only AGM or Gel-Cell batteries to reduce the risk of leakage or explosive conditions.



WARNING! Corrosive chemicals contained in battery.



WARNING! Contact with tools can cause electrical shock.



WARNING! Connect the battery harnesses in the proper manner. RED (+) cables must be connected to positive (+) battery terminals/posts. BLACK (-) cables must be connected to negative (-) battery terminals/posts. REPLACE cables immediately if damaged. Protective caps must be installed over all battery terminals.

VI. CARE AND MAINTENANCE

NOTE: If you encounter a damaged or cracked battery, immediately enclose it in a plastic bag and call your local disposal agency or authorized Pride Provider for instructions on disposal and recycling, which is our recommended course of action.

Follow these steps to replace the onboard battery (figure 11):

1. Unfasten the battery securement strap located at the bottom of the battery box.
2. Remove the hardware from the battery securement bracket and remove the bracket.
3. Remove the hardware from the battery connector.
4. Slide the battery out of the battery box to expose the battery harness.
5. Disconnect the battery harnesses from the battery terminals.
6. Connect the battery harnesses to the new battery.
7. Slide the new battery into the battery box.
8. Reinstall the hardware to secure the battery connector and tighten.
9. Reinstall the battery securement bracket and tighten the hardware.
10. Refasten the battery securement strap.

If your lift system is exhibiting wear that you feel is questionable in any way, contact your authorized Pride Provider immediately. Do not attempt to repair, adjust, or modify the manufacturer settings and materials.

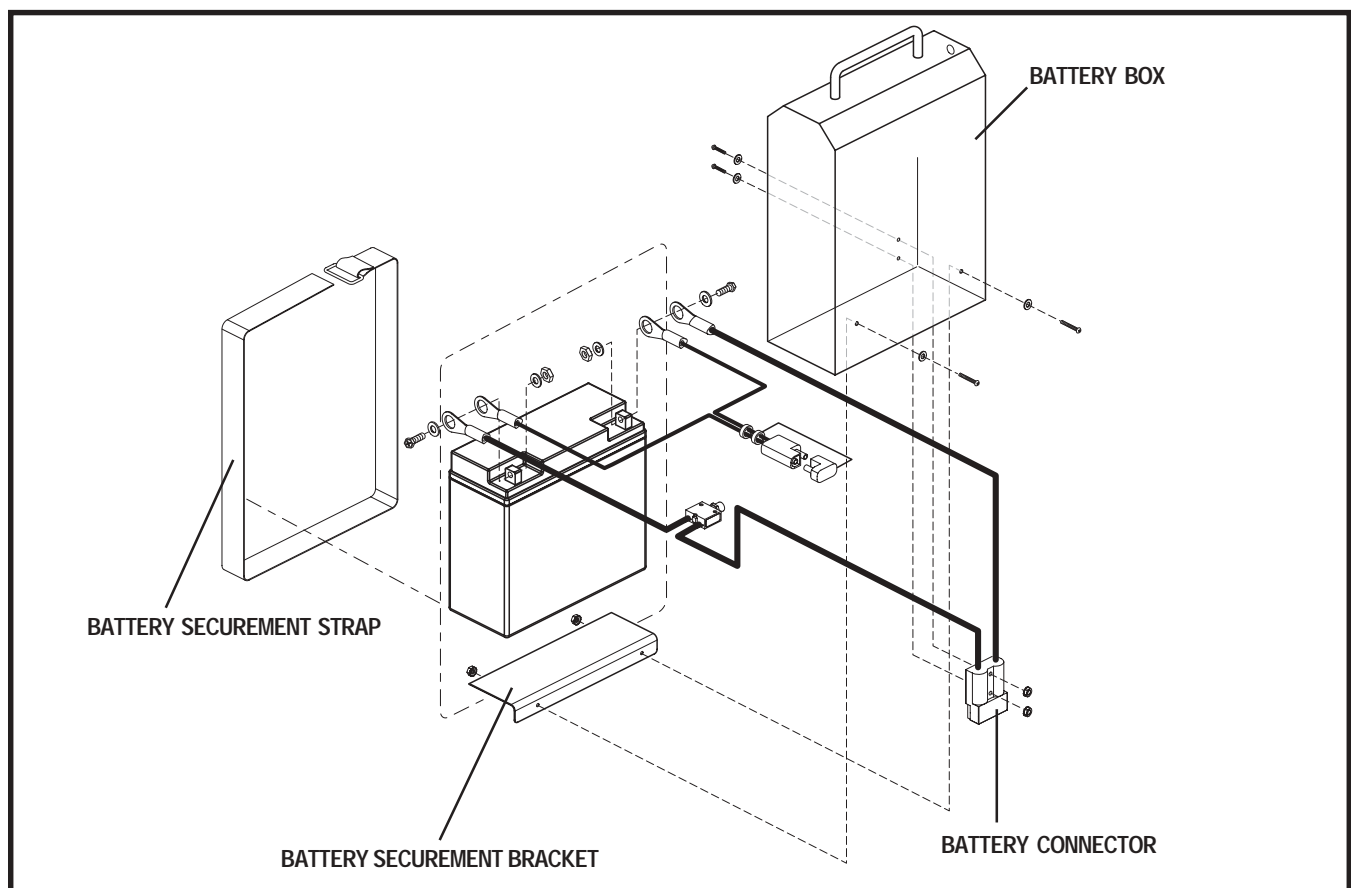

Figure 11. Battery Replacement

VII. TROUBLESHOOTING

TROUBLESHOOTING

Any electromechanical device occasionally requires some troubleshooting. However, most of the problems that may arise can usually be solved with a bit of thought and common sense. Many of these problems occur because the batteries are not fully charged or because the batteries are worn down and can no longer hold a charge.

What if the motor on my lift system will not operate?

- Make sure the onboard battery or vehicle battery is fully charged.
- Make sure all connections to the motor and battery are secure.
- Check the wiring harness for signs of wear or decay. Replace the harness if necessary.

What if the lift system operates slowly up or down?

- Make sure the onboard battery or vehicle battery is fully charged.
- Make sure all connections to the motor and battery are secure.
- Check the wiring harness for signs of wear or decay. Replace the harness if necessary.

What if the lift platform does not lower completely to the ground?

- Check to make sure that the area under the lift platform is free from obstructions.

VIII. SPECIFICATIONS

SPECIFICATIONS	
Lift System Dimensions	Overall Base Rail Length: 45 in. (114.30 cm) Overall Base Rail Width (including platform): 11.5 in. (29.21 cm) Overall Height: 37.2 in. (94.61 cm) Platform Length: 44 in. (111.76 cm) Platform Width: 28 in. (71.12 cm)
Total Lift System Weight	155 lbs. (70 kg) including standard platform
Base Lift Weight	98 lbs. (44.5 kg)
Maximum Lift Capacity	325 lbs. (147 kg)
Mobility Device Dimensions	Length: 44 in. (111.76 cm) ¹ Height: 34 in. (86.36 cm) ¹ Width: 27.5 in. (69.85 cm)
Maximum Lift Travel Distance	26 in. (66 cm) vehicle floor to ground
Motor	Fully sealed, 12-volt DC
Onboard Battery (Type I) BATASMB1030	Battery: 12-volt, 18 Ah Weight: 12 lbs. (5.44 kg) Charger: 110-volt, off-board ²
Onboard Battery (Type II) With Integrated Battery Charger BATASMB1049	Battery: 12-volt, 8Ah Weight: 10.5 lbs. (4.8 kg)

¹ Depending on vehicle dimensions.

² Use the supplied charger only.

I X . W A R R A N T Y

THREE-YEAR TRANSFERABLE LIMITED WARRANTY

For three (3) years from the date of purchase, Pride Mobility Products will repair or replace at our option, free of charge, any mechanical or electrical component found upon examination by an authorized representative of Pride to be defective in material and/or workmanship.

This warranty does not extend to those items, which may require replacement due to normal wear and tear.

- Labor, service calls, shipping, and other charges incurred for repair of the product, unless specifically authorized by Pride Mobility Products Corporation IN ADVANCE, are excluded.

Exclusions also include components with damage caused by:

- Contamination
- Abuse, misuse, accident, or negligence
- Battery fluid spillage or leakage
- Commercial use, or use other than normal
- Improper operation, maintenance, or storage
- Repairs and/or modifications made to any part without specific consent from Pride Mobility Products Corporation.
- Circumstances beyond the control of Pride

ONE-YEAR WARRANTY

The battery is covered by a separate one (1) year warranty provided by the battery manufacturer. The batteries are not warranted by Pride Mobility Products Corporation.

SERVICE CHECKS AND WARRANTY SERVICE

An authorized Pride Mobility Products Provider must perform warranty service. Do not return faulty parts to Pride Mobility Products without prior written authorization. All transportation costs and shipping damage incurred while submitting parts for repair or replacement is the responsibility of the purchaser.

Failure to follow the instructions, warnings, and notes in the owner's manual and those located on your Pride lift product can result in personal injury or device damage and will void Pride's product warranty.

There is no other express warranty.

IMPLIED WARRANTIES

Implied warranties, including those of merchantability and fitness for a particular purpose, are limited to one (1) year from the date of purchase and to the extent permitted by law. Any and all implied warranties are excluded. This is the exclusive remedy. Liabilities for consequential damages under any and all warranties are excluded.

Some states do not allow limitations on how long an implied warranty lasts or do not allow the exclusion of limitation incidental or consequential damages. The above limitation or exclusion may not apply to you.

This warranty gives you specific rights, and you may also have other rights, which vary from state to state.

Please fill out and return the device registration card to Pride Mobility Products. This will aid Pride in providing the best possible technical and customer service.

NOTES



Pride® **SilverStar**™ ☆
Lifts & Ramps

Pride Mobility Products Corp.
182 Susquehanna Avenue
Exeter, PA 18643-2694
www.pridemobility.com
www.silverstarmobility.com