

PHOENIX 4 WHEEL



Phoenix 4 Wheel, Compact Scooter

S35015 Red/Blue, 1/cs

FEATURES:

- For indoor and outdoor use.
- New interchangeable color panels (red & blue) included.
- 4 wheel model allows for 44" turning radius and added stability.
- Convenient, compact design makes assembly/disassembly easy.
- Easy to assemble and disassemble with 4 pieces.
- Comes with easy to remove wireless battery that can be charged separately from the scooter.
- Comes with headlight.
- New "Finger-pull" throttle.
- Comfortable height adjustable, upgraded seat.
- Flip back adjustable width arms.
- Speed ranges from 5 mph to 4 mph and a cruising range of 15 miles.
- Stackable battery box will allow an optional battery for increased range up to 30 miles.
- Comes standard with anti tipplers.
- Convenient free-wheel release knob.
- Flat free tires.
- Large carry basket.
- Easy to adjust tiller.
- For added safety the tiller has an auto straightening function.
- Has been tested and surpassed the ANSI RESNA testing requirement.
- 70 amp drive CTE electronics.
- 300 lb. Weight Capacity.



NEW

INTERCHANGEABLE
COLOR PANELS
(RED & BLUE)
INCLUDED



STACKABLE BATTERY
DOUBLES YOUR RANGE
UP TO 20 MILES.

ADDITIONAL BATTERY
ITEM# S3BATT



EASY TO ASSEMBLE
AND DISASSEMBLE
INTO 4 PIECES

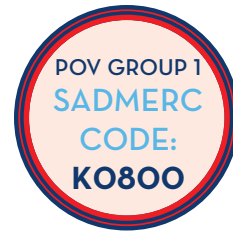

Royal Blue



Red

PHOENIX 4 Wheel PARTS DIAGRAM

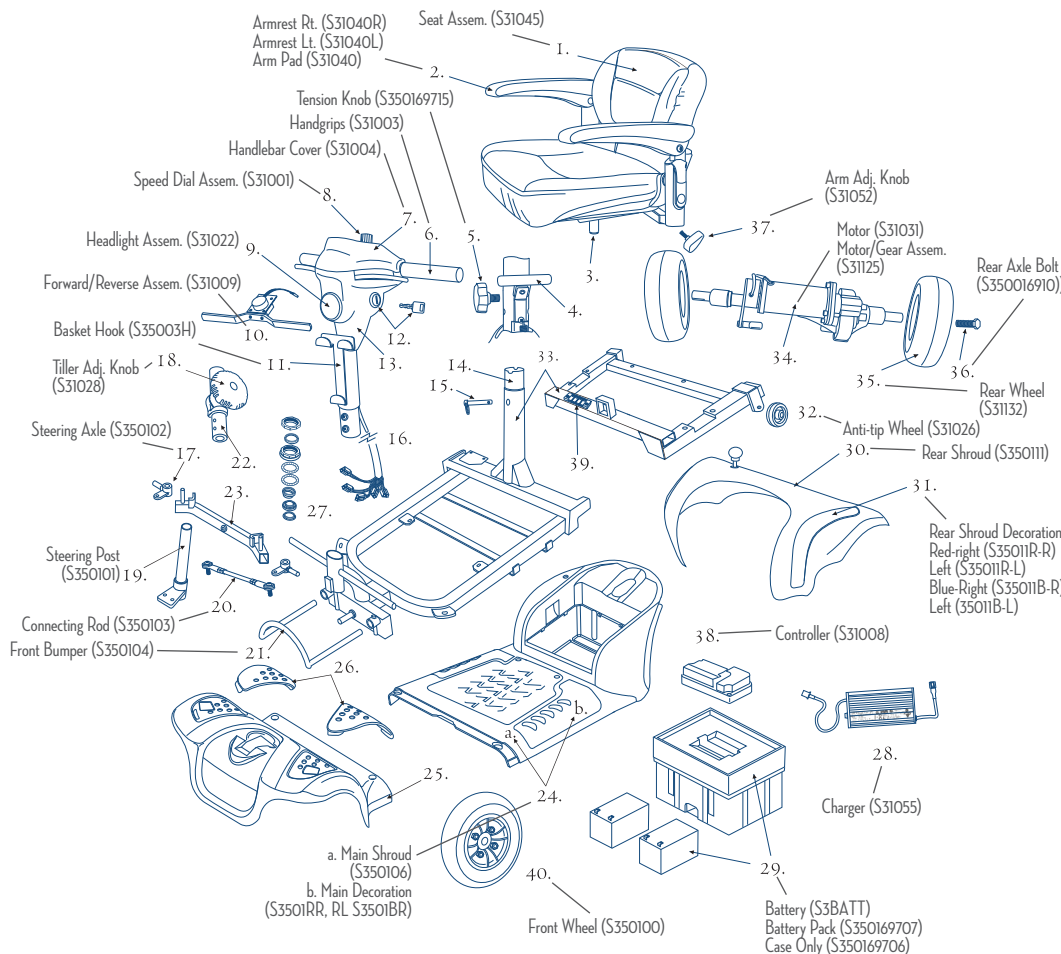

- 3. Seat Plate (S31039)
- 4. T Handle Frame Lock (S350169716)
- 12. Key Switch Assem. (S31006)
Key (S3KEY)
- 13. Red (S31209R)
Blue (S31209B)
- 14. Seat Post (S31049)
- 15. Seat Pin (S350169717)
- 16. Wire Harness -
Front Tiller (S31048)
Rear Section (S31058)
- 22. Tiller Swivel Assem. (S350109)
- 23. Front Fork (S350105)
- 25. Front Shroud (S350107)
- 26. Front Decoration
Rt. S3501RR-1, RL-1
Lt. S3501BR-1, BL-1
- 27. Bearing Assem. (S31021)
- 33. Rear Frame (S31130)
Front Frame (S350108)
- 39. Frame Contact- Front (S31056)
Rear (S31057)

SPECIFICATIONS

ITEM #	S35015
L X W	37.8" X 20"
SADMERC CODE GROUP	GROUP 1/K0800
REAR WEIGHT	24 LBS
FRONT WEIGHT	41 LBS
SEAT WEIGHT	26 LBS
BATTERY WEIGHT	20 LBS
GROSS WEIGHT	111 LBS
DYNAMIC STABILITY INCLINE IN DEGREES	10°
MINIMUM OBSTACLE CLIMBING ABILITY	1"
SEAT DIMENSIONS	17"(D) X 17.5"(W)
SEAT TO FOOT DECK HEIGHT	17" - 19"
DRIVE WHEEL	8" SOLID
CASTER WHEEL	8" SOLID
BATTERY (INCLUDED)	12AH, 12V X 2
CHARGER	2 AMP OFF BOARD
MAX. SPEED	4 MPH
MAX. WEIGHT LOAD	300 LBS
CRUISING RANGE	UP TO 15 MILES (30 MILES WITH STACKABLE BATTERIES)
SAFE CLIMBING ANGLE	8°
TURNING RADIUS	44"
GROUND CLEARANCE	2"
MOTOR	270W X 1
ANTI-TIP WHEEL	2"
CHARGING TIME, HOURS	APPROX 6 HR
CONTROLLER	DRIVE 70A
WARRANTY	LIFETIME ON FRAME ONE YEAR ON ELECTRONIC CONTROLLER AND DRIVE TRAIN COMPONENTS SIX MONTHS ON BATTERY (FROM DATE OF INSTALLATION)

powered mobility

drive
WWW.DRIVEMEDICAL.COM

To order call toll free: 877.224.0946